

THE SERIAL NUMBER

of a product is written on of the label applied on the product which indicates a code preceded by S/N (Serial Number), N. Matr. (Serial number), etc ... to search generally on the back, inside or on the side of the product.

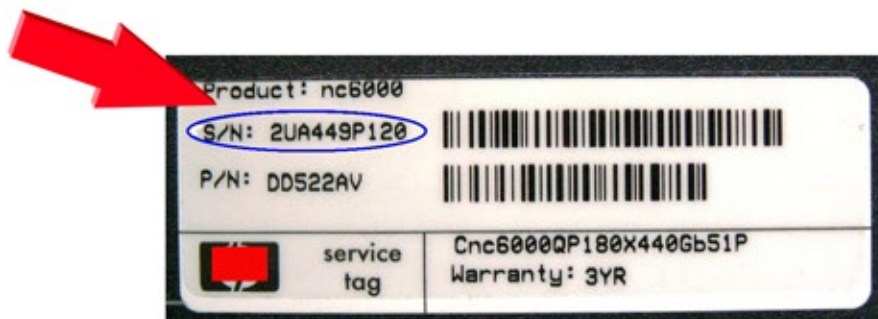

THE SERIAL NUMBER

It should be filled the form: Serial number of the coupon found inside the Warranty3 certificate. The coupon must be filled in every part and sent with a copy of the purchase document and original warranty issued by the manufacturer, if present, all by registered letter with return receipt to Business Company Ltd.

coupon da inviare

nome		
cognome		
indirizzo		
rag.soc./p.iva		
città		
prov.	Cap.	tel.
e-mail		
prodotto		
marca		
modello		
codice seriale		
importo €		data acquisto

ONLINE ACTIVATION:

You can activate your certificate also online at:
<http://www.garanzia3.it/attivazione-estensione-servizio-tecnico-online/>
Also in this case the: **Serial Number**, must be reported in the form: "Serial number" for online activation.

Completa il modulo per inoltrare la richiesta di attivazione

I campi contrassegnati col simbolo * (asterisco) sono obbligatori.

Num. contratto / PIN - GARANZIA3 *

Istruzioni ricerca Numero Contratto/PIN

Tipologia/Categoria (del prodotto da garantire)*

Modello (del prodotto da garantire)*

Marca (del prodotto da garantire)*

Codice seriale (del prodotto da garantire)*

Istruzioni ricerca Codice Seriale su prodotti

FRIDGE:

Generally the label with the serial number is applied

or inside:

- in the food drawer
- on the top near to the lamp

or:

- on the back side
- on the lateral side



DISHWASHER:

Generally the label with the serial number is applied on the lateral profile of the door itself.

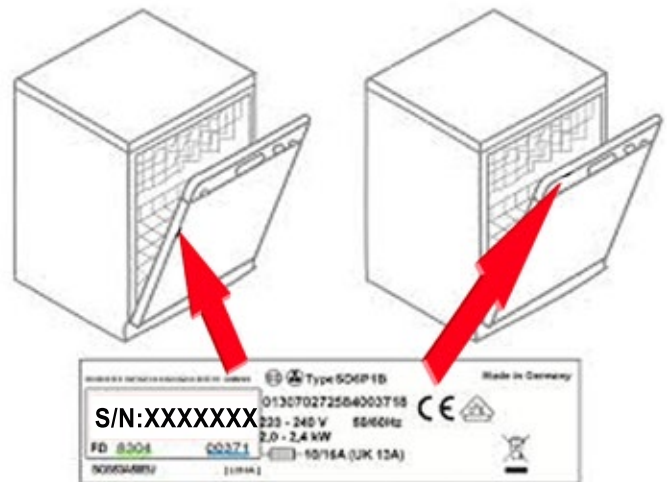

WASHING MACHINE:

Generally the label with the serial number is applied:

- on the porthole or inside
- on the lower part
- on the back side

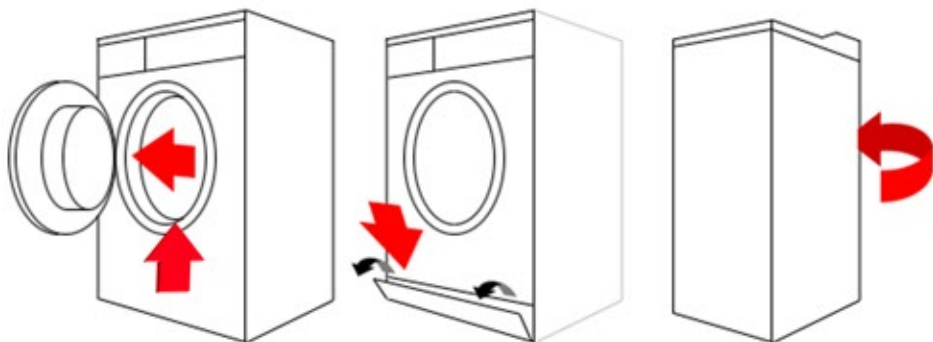

OVEN:

Generally the label with the serial number is applied:

- on the inner part
- on the lateral side.

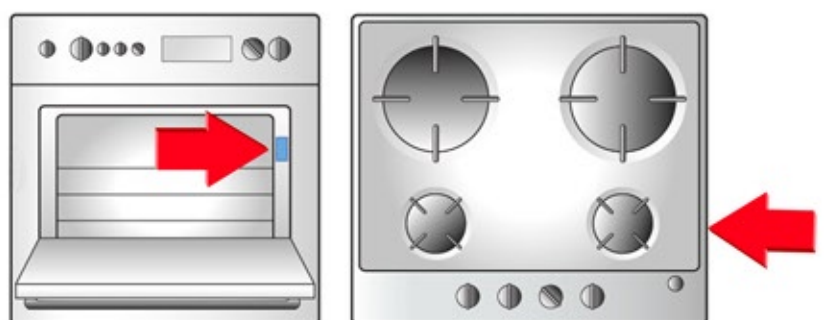

NOTEBOOK:

Generally the label with the serial number is applied: on the basic unit.



TV:

Generally the label with the serial number is applied: on the back side.



SMARTPHONE:

Generally the label with the serial number is applied: inside under the battery.
You can also communicate the IMEI code.

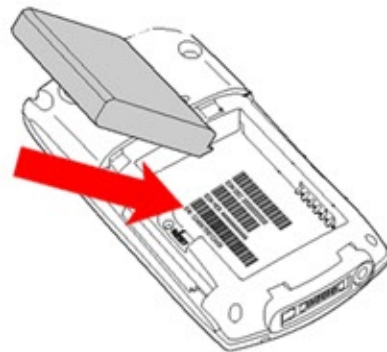

PC:

Generally the label with the serial number is applied: to the back or on the lateral side.

